

USING THE DEVICE

Your device gives you the capability of using several functions:

- **The 2h Boost function**, which enables you quickly to raise your room's temperature. Your device will operate at maximum power for 2 hours.
- **The 24h Auto function** , which enables you to repeat the 2h Boost function every 24 hours. Your device will operate at maximum power for 2 hours every day of the week at the same time.

Control box

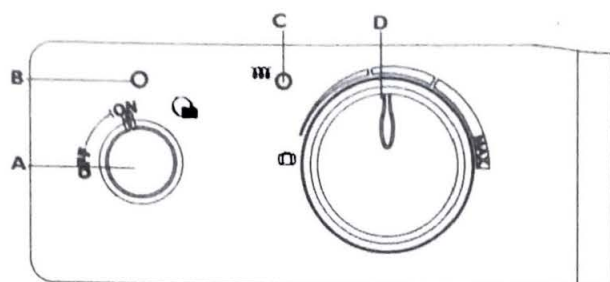

- A** Mode selection and control locking wheel.
- B** 2h and 24h Boost and locking function operating light
- C** Heating light
- D** Temperature setting wheel

Central programming control (see *programmer instructions*)

Centralised programming (via the Pilot Wire) enables you to make savings by programming temperature reductions when you wish, depending on the bathroom's period of use.

Switching on and finding the right heating temperature

The device is designed to provide the heat and comfort you require in your bathroom.

To switch on your device, position the mode selection wheel **A** to ON.

To set the device to standby mode, set the mode selection wheel **A** to OFF.

Position the temperature setting wheel **D** to . The heating light **C** lights up if the ambient temperature is less than that displayed.

Wait at least 6 hours for the temperature to stabilise.

If you are dissatisfied with the room's temperature, set the temperature setting wheel **D** to .

How to raise the room's temperature quickly : use of the 2h Boost function

To activate the 2h Boost function, set the mode selection wheel **A** to ON; then hold down wheel **A** for approx. 1 second.

Light **B** comes on. The heating light **C** is lit.

Your device operates at maximum power for 2 hours and then returns to normal operation (heating the room to the temperature you have chosen).

To switch off the 2h Boost function (before 2 hours have expired), hold down wheel **A** again for approx. 1 second.

Light **B** goes out.

Your device resumes normal operation.

How to raise the room's temperature quickly every day : how to use the 24h Auto function

To activate the 24h Auto function, set the mode selection wheel **A** to .

You can switch off this function before two hours have expired by holding down wheel **A** for approx. 1 second.

Light **B** comes on. The heating light **C** is lit.

Your device operates at maximum power for 2 hours and then returns to normal operation (the same as when set to **ON**).

When you activate the 24h Auto function, the 2h Boost function comes on.

The 2h Boost function comes on for a second time the following day 45 minutes before the programmed time for the initial start and then at the same time every day of the week.

Example of use :

You wish to have your optimum comfort temperature at 7 AM.

On the first day, at 7AM, set the mode selection **A** to . Your device starts to heat at maximum power for 2 hours and then resumes normal operation after 2 hours.

On the following day and the days after, your device will heat at full power at 6:15 AM to provide your comfortable temperature at 7 AM.

To activate the 2h Boost function outside the set hours for the 24h Auto function, press the mode selection wheel **A**.

You can switch off this function before the two hours have expired by holding down wheel **A** for approx. 1 second.

Light **B** comes on. The heating light **C** is lit.

Your device operates at maximum power for 2 hours and then returns to normal operation (the same as when set to **ON**).

To switch off the 24h Auto function, change the position of the mode selection wheel **A**.

Your device resumes normal operation. The 24h Auto function is deactivated.

Locking the controls: how to use the Locking function

This function enables you to lock the heating mode you have selected (e.g.: mode **ON**, temperature set with the wheel on ). It is used to prevent any untimely operation of the device (by children, etc.).

To activate the Locking function, hold down the mode selection wheel **A** for more than 3 seconds (the wheel may be at any position except **OFF**).

Light **B** flashes 5 times: the settings are locked.

The selected temperature cannot be altered.

You can still use the 2h Boost function by pressing wheel **A** (if the wheel **A** were set to **ON** or .

To switch off the Locking function, hold down the mode selection wheel **A** for more than 3 seconds.

Light **B** flashes 5 times: the settings are locked.

You can change the position of the mode selection wheel **A** but any changes will not be registered.



- If you change the position of the mode selection wheel **A**, light **B** flashes.

- If you change the position of the temperature setting wheel **D**, the temperature will not change.

GB

HOW TO INSTALL THE PEG? (FOR CHROMED MODEL)

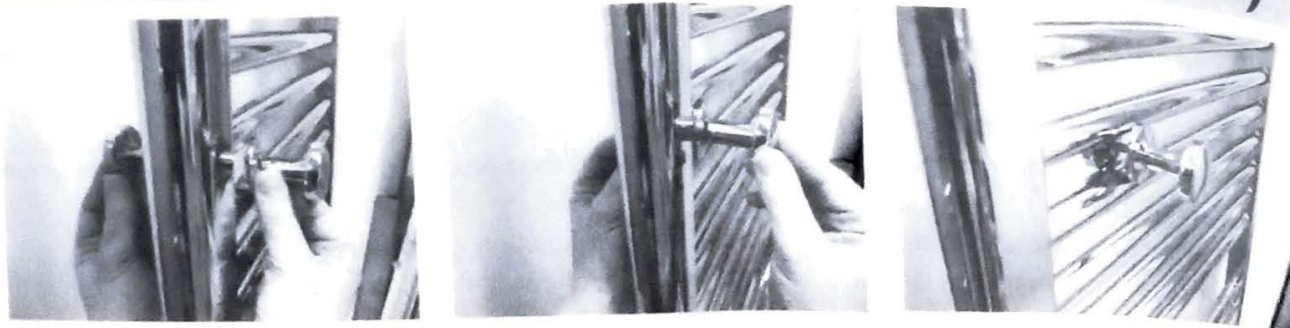

RECOMMENDATIONS OF USE

- It is useless to set the device to maximum power, the bathroom temperature will not rise any faster.
 - For optimum heating, the towels must be arranged on the heating slats and bathrobes on the hooks provided (*Chromed Model*).
 - If you will be away for more than 48 hours : set the mode selection wheel **A** to **ON** and the temperature setting wheel **D** to .
- Your device will keep the temperature at 7°C ($\pm 3^{\circ}\text{C}$).

IN CASE OF PROBLEM

Problems Encountered	Checks to be made
The device does not heat	<ul style="list-style-type: none"> - Ensure that the main circuit breakers are closed or that the overload cut-out has not cut off the supply to the advice. - Check the air temperature in the room.
The device heats all the time	<ul style="list-style-type: none"> - Check that the device is not located in a draft or that the temperature setting has not been changed. - There may be a fluctuation in the electricity supply. If you experience a problem (<i>thermostat locked, ...</i>), cut off the electricity supply to the towel-dryer (via the fuse or circuit breaker) for approx. 10 minutes and the switch it on again. - If you encounter the same phenomenon frequently, have your power supply checked by your local utility.
The surface of the advice is very hot.	It is normal for the device to be hot when it is operating; the maximum surface temperature is limited in accordance with the prevailing standard. If, nevertheless, you think your advice is always too hot, check that the output is suitable for the size of your room (we recommend 50W / m ²) and that the advice is not located in a draft interfering with its automatic controls. The last elements, top and bottom, are more tepid than the rest of the advice
The last elements, top and bottom, are more tepid than the rest of the advice	<ul style="list-style-type: none"> - In the case of the top one, the upper elements are not completely filled to allow for expansion of the thermodynamic fluid. They heat up only by conduction. - In the case of the bottom one, the lower elements channel the returning fluid after it has transmitted its heat.
24h Auto mode does not repeat every day.	<ul style="list-style-type: none"> - Check that the electricity supply has not been interrupted at any time. The position of the mode selection wheel A may have been changed (refer to the section on page 15).